

Field Specifications

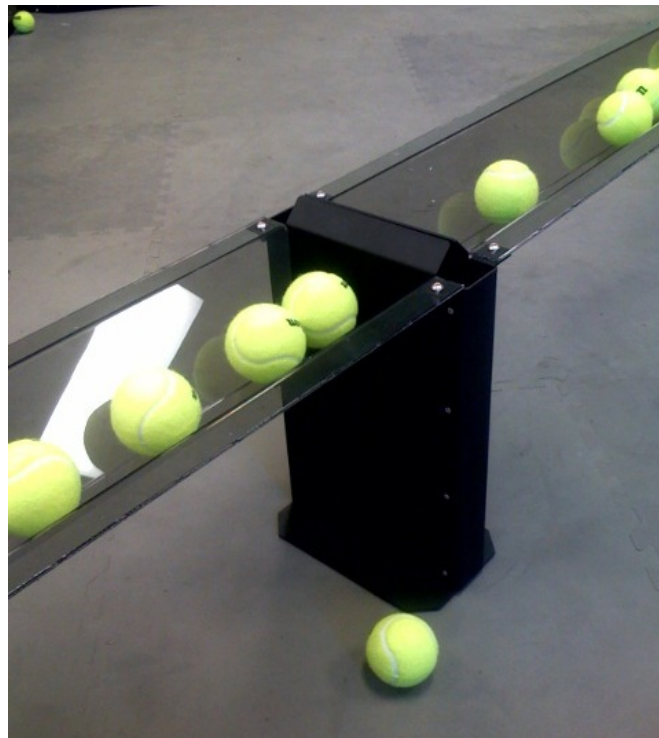

This section will outline the specifications which are most important to teams designing a robot to compete in Bridge-Battle. Though many of the critical dimensions are included in this section, it may be necessary to consult the assembly guide and 3D CAD models of the field for additional detail.

Field components may vary slightly from event to event. This is to be expected; teams will need to adapt accordingly. This minor variance can be considered part of the design challenge.

For instance the edge of the goals is approximately 14.5” off the floor. A robot which scores at this exact height, and cannot go any higher is poorly designed. It is in a team’s best interest to design their robot to reach higher than this dimension, in the event that the goal height varies above the spec.

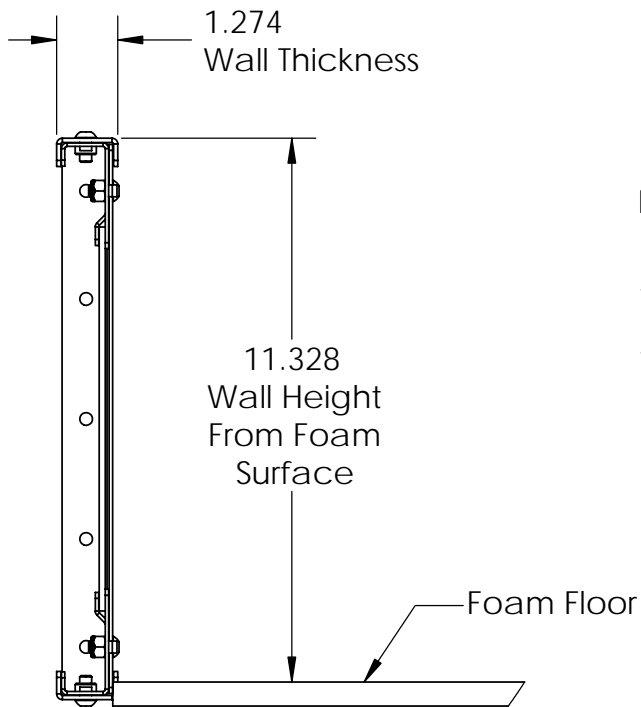
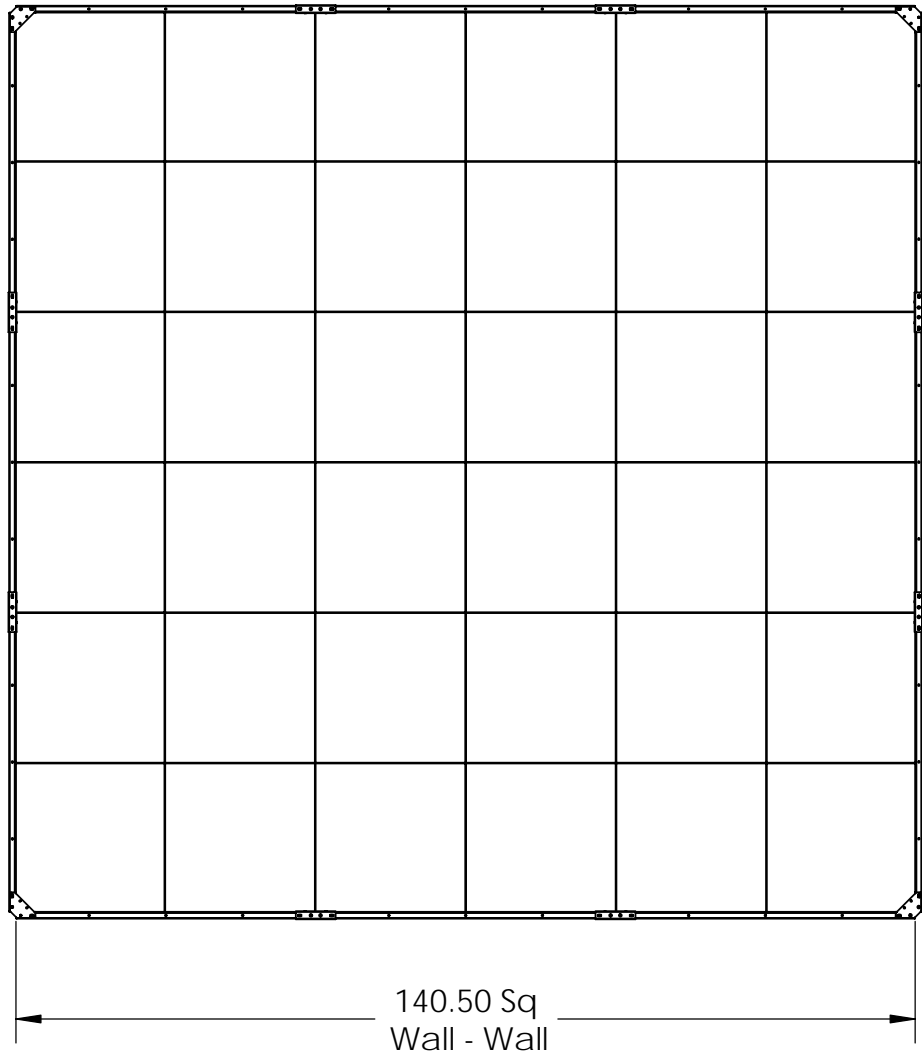

**Field Inside Dimensions:
~140.5" Square Wall-Wall**

11.328" Wall Height

1.27" Wall Thickness

Printed on 8/14/2007 ALL DIMENSIONS ARE IN INCHES.

VexRobotics.com
Field Perimeter Specs

Part Number

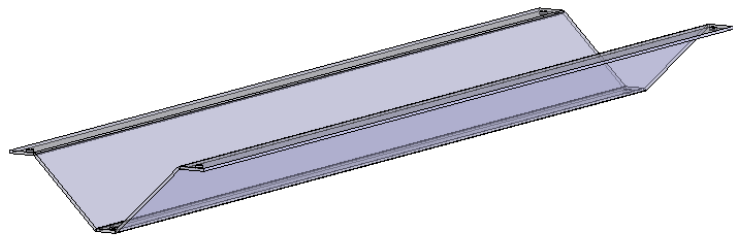
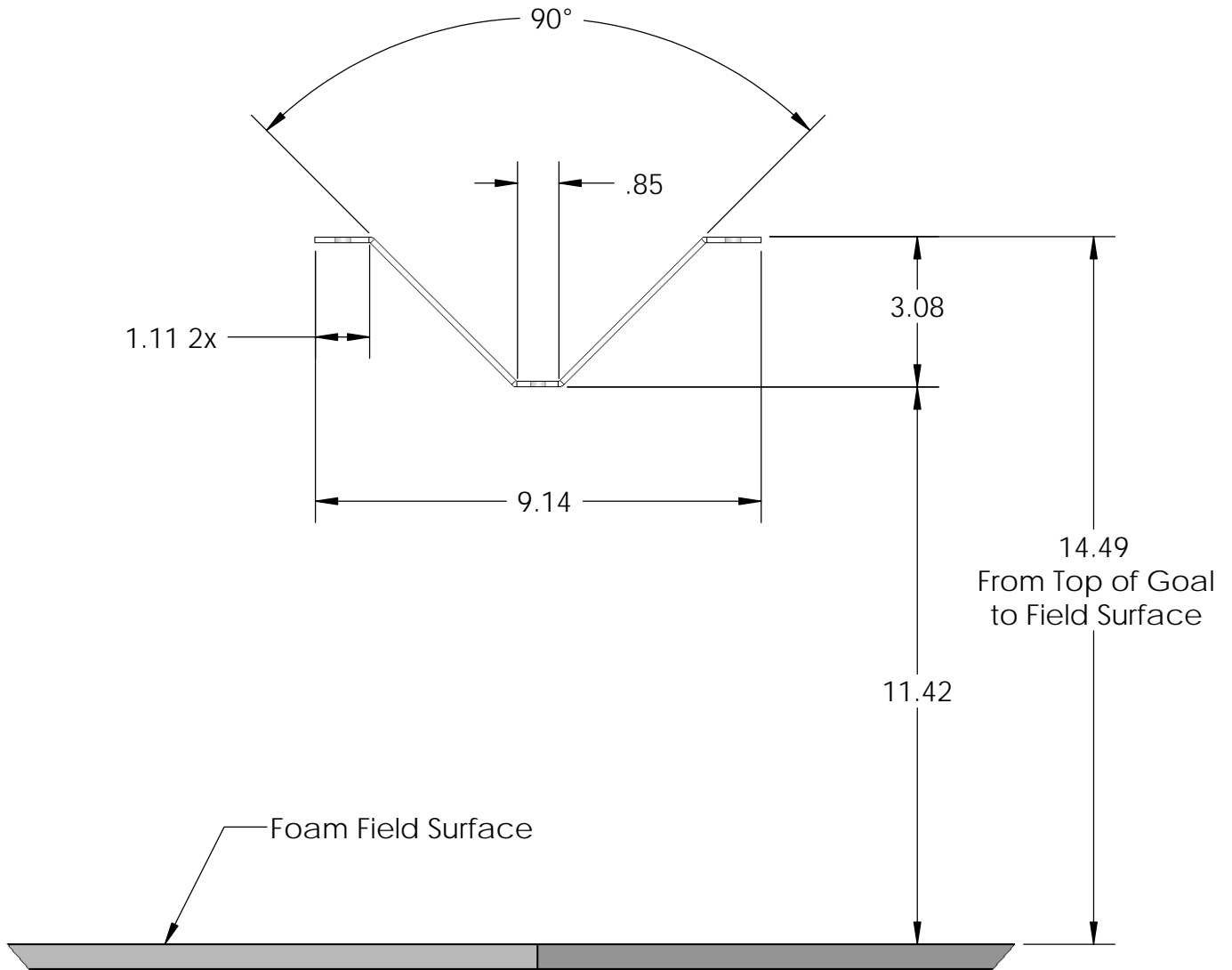

Trough Goal is made from 1/8" Thick Lexan with Sheet-Metal Support Brackets.

Refer to field 3D Solid Models for additional details and dimensions.

Printed on 8/14/2007 ALL DIMENSIONS ARE IN INCHES.

VexRobotics.com

Goal Specs

Part Number

BRIDGE-BATTLE-FIELD-SPECS

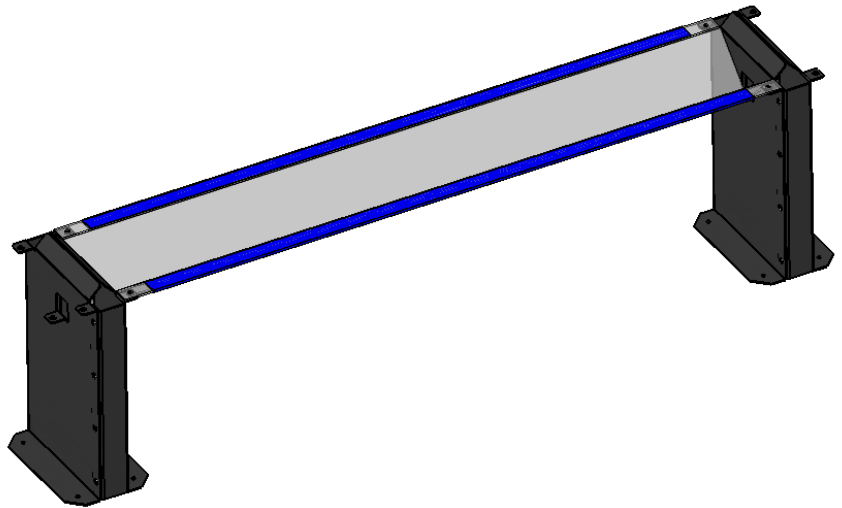
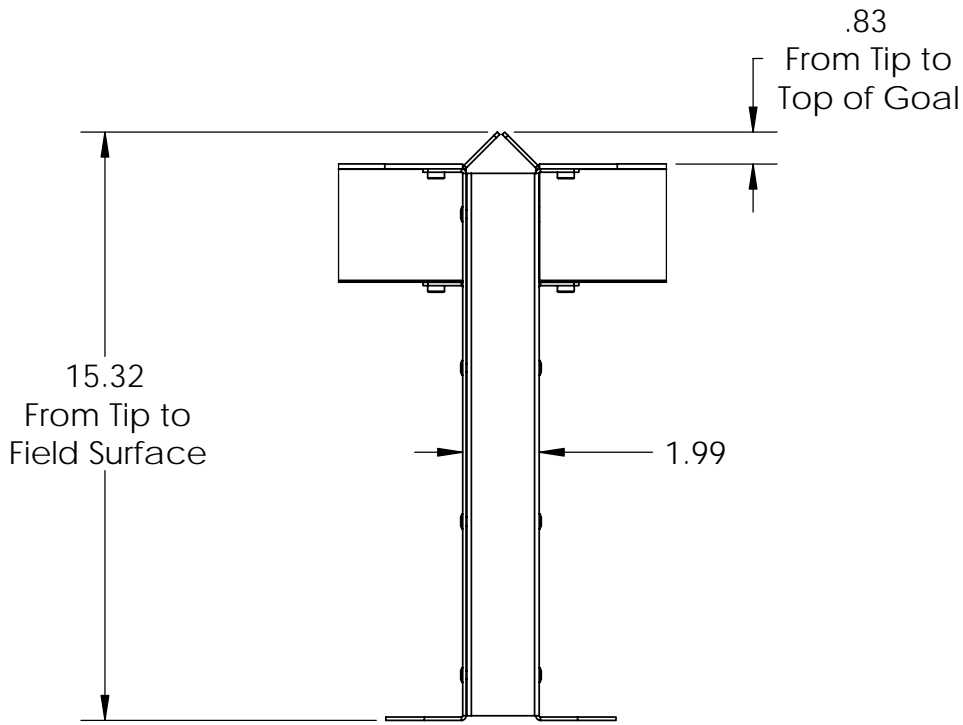
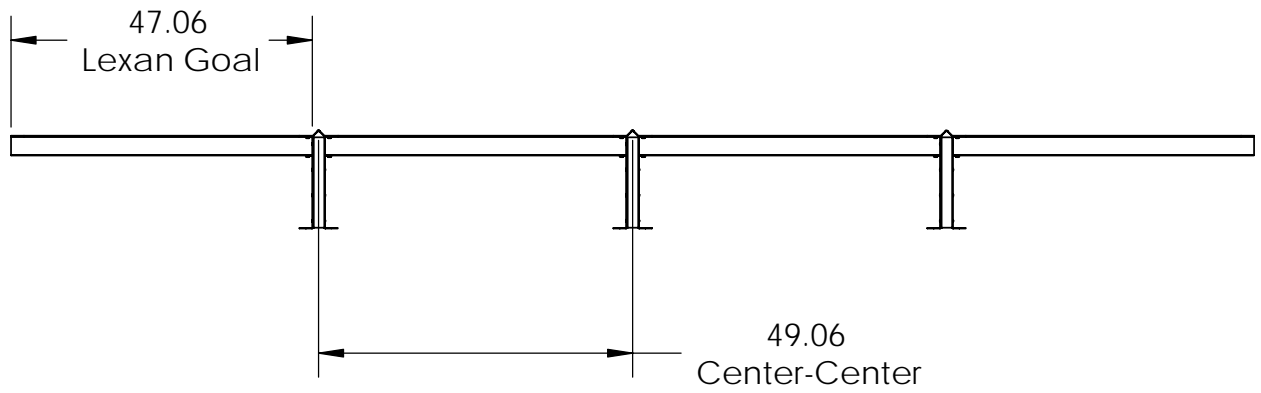

Trough Goal is made from 1/8" Thick Lexan with Sheet-Metal Support Brackets.

Refer to field 3D Solid Models for additional details and dimensions.

Printed on 8/14/2007 ALL DIMENSIONS ARE IN INCHES.

VexRobotics.com

Goal Support Specs

Part Number

BRIDGE-BATTLE-FIELD-SPECS

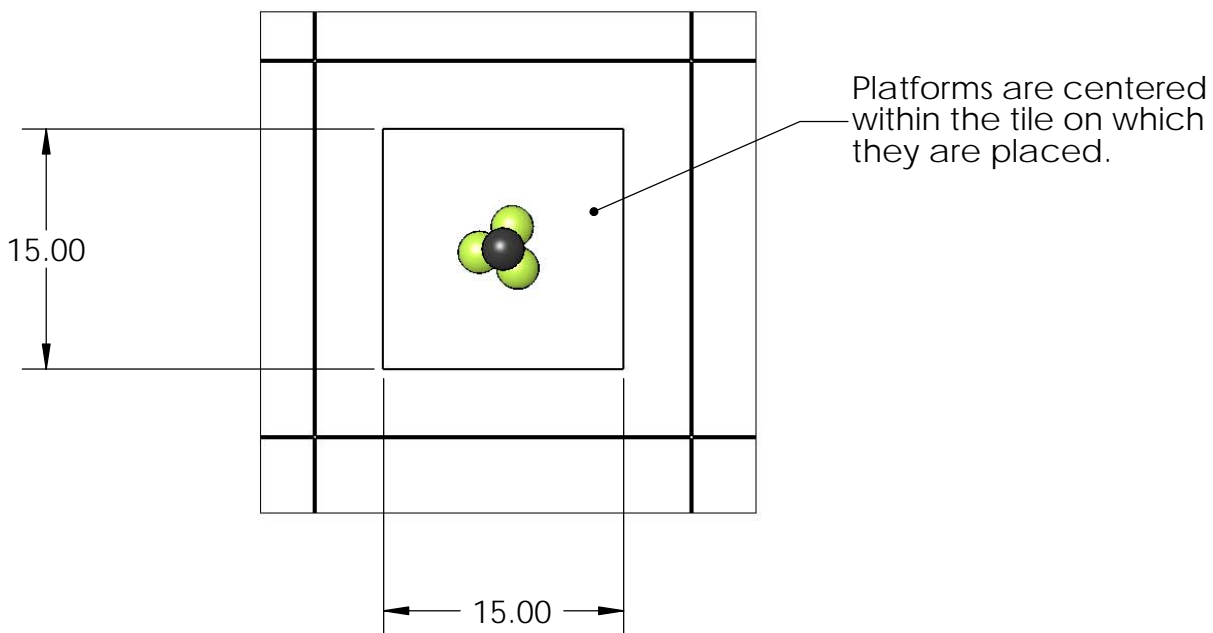
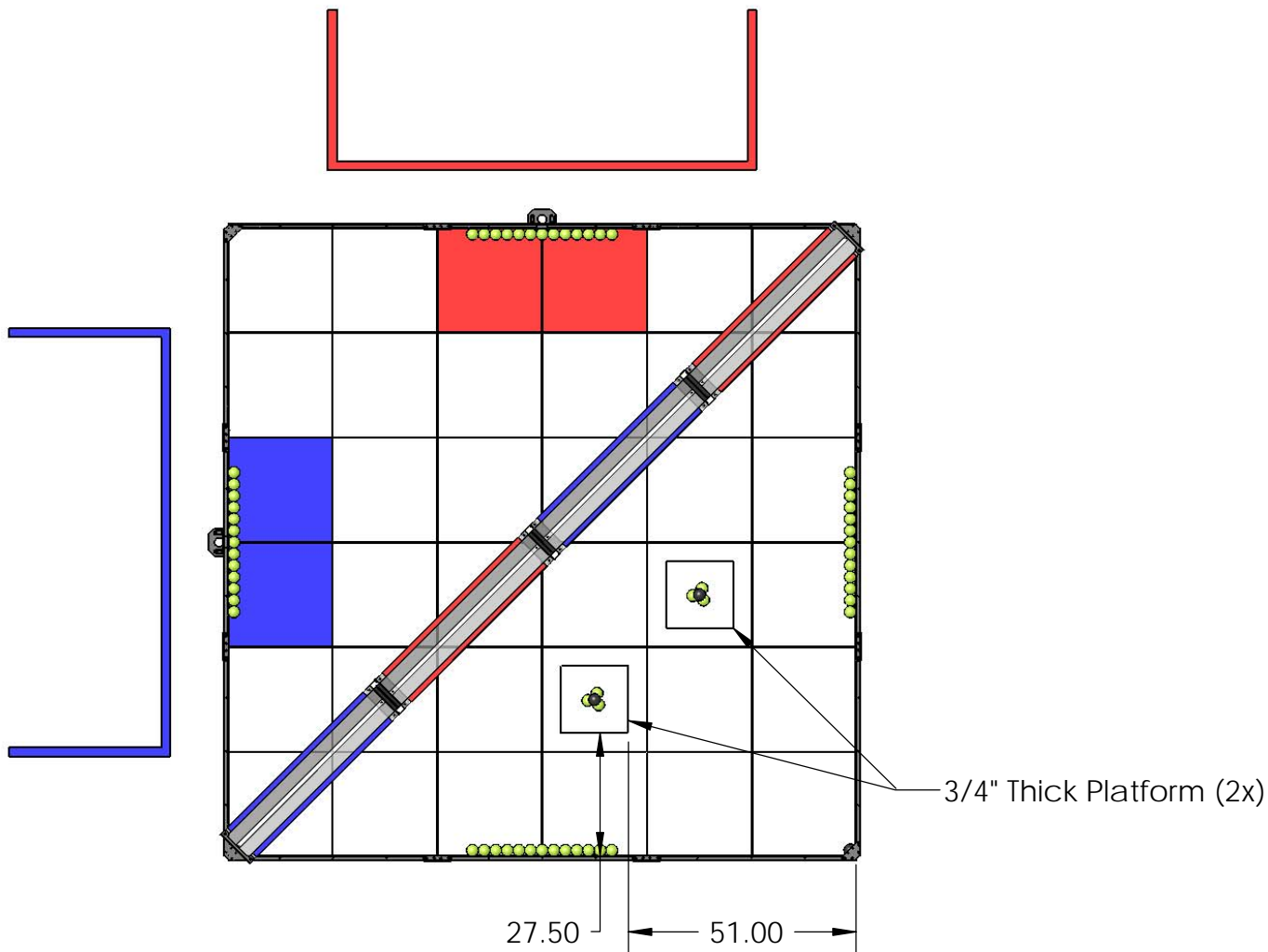

Platforms are made from 3/4" Plywood.

Refer to field 3D Solid Models for additional details and dimensions.

Printed on 8/14/2007 ALL DIMENSIONS ARE IN INCHES.

VexRobotics.com
Platform Specs

Part Number

BRIDGE-BATTLE-FIELD-SPECS

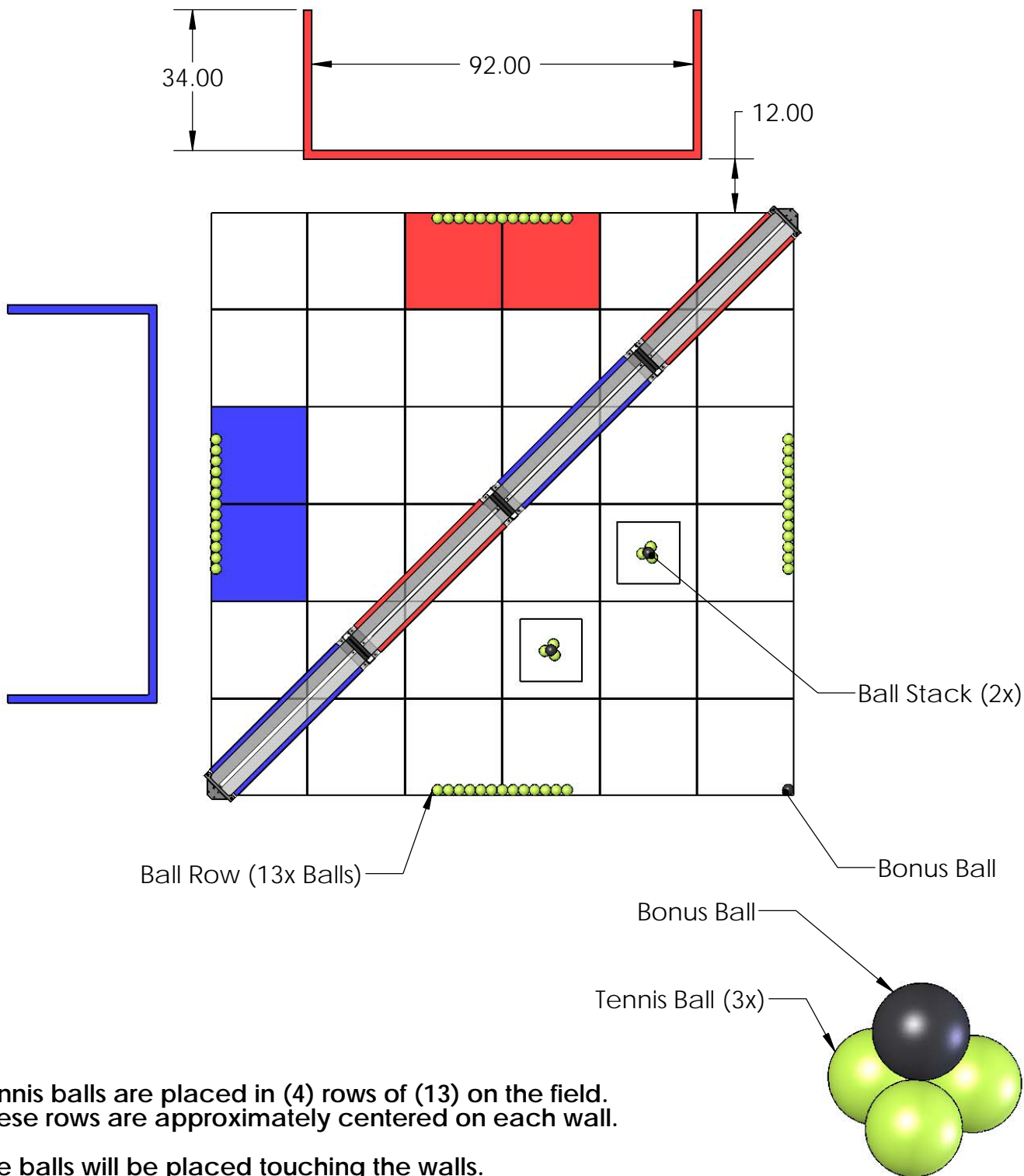

Tennis balls are placed in (4) rows of (13) on the field. These rows are approximately centered on each wall.

The balls will be placed touching the walls.

One bonus ball is placed in the corner closest to the audience.

On top of each platform is a stack of 4-balls. These stacks will be placed at the approximate center of each platform.

The Bonus Ball will always be placed on top.

The stacks are randomly oriented. i.e. the pyramid corners will not point in any specific direction.

Ball Stack

Printed on 8/14/2007

ALL DIMENSIONS ARE IN INCHES.

VexRobotics.com

Ball Placement Spec

Part Number

BRIDGE-BATTLE-FIELD-SPECS

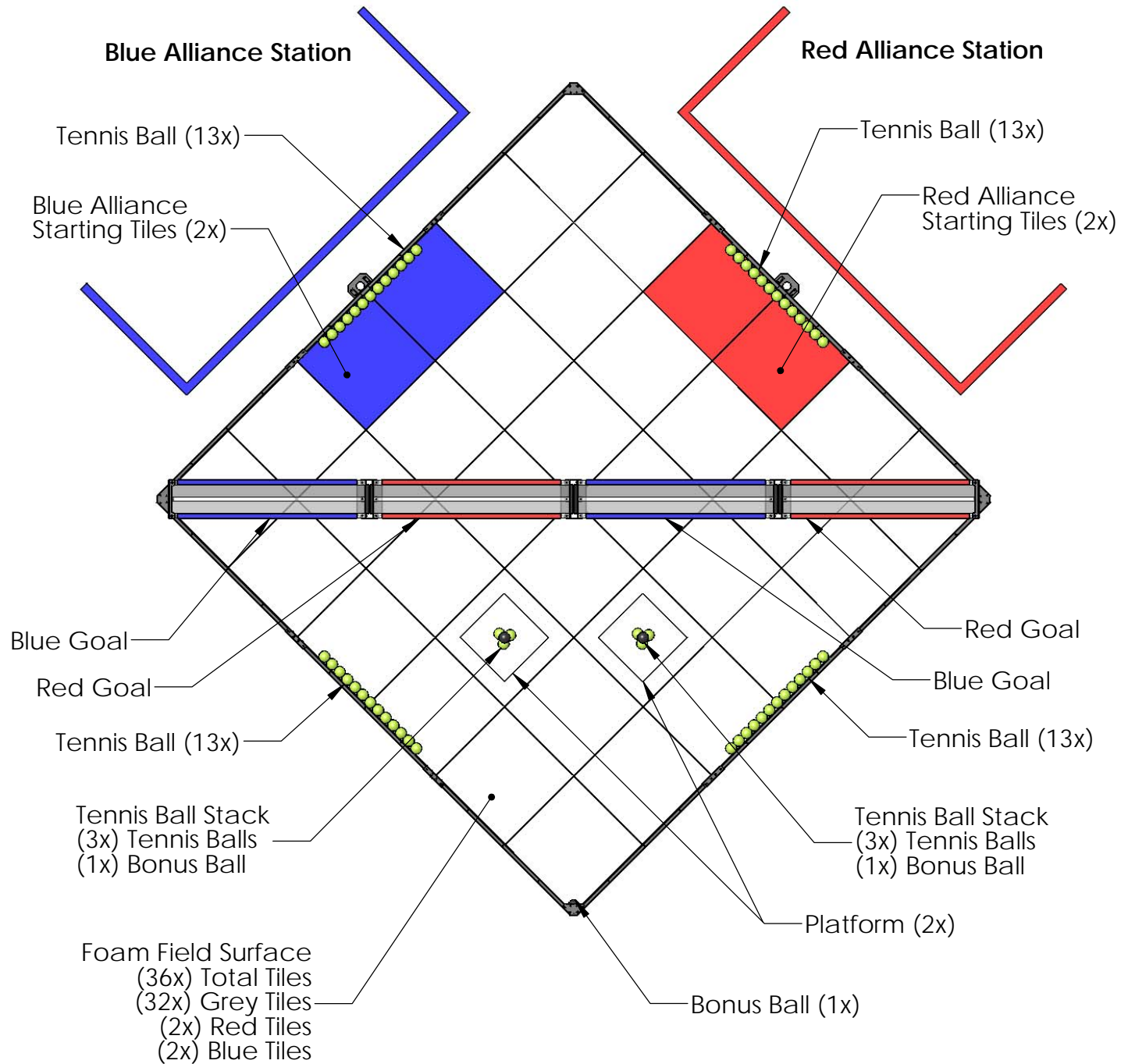

Printed on 8/14/2007 ALL DIMENSIONS ARE IN INCHES.

VexRobotics.com
 Overall Field Layout

Refer to field 3D Solid Models for additional details and dimensions.

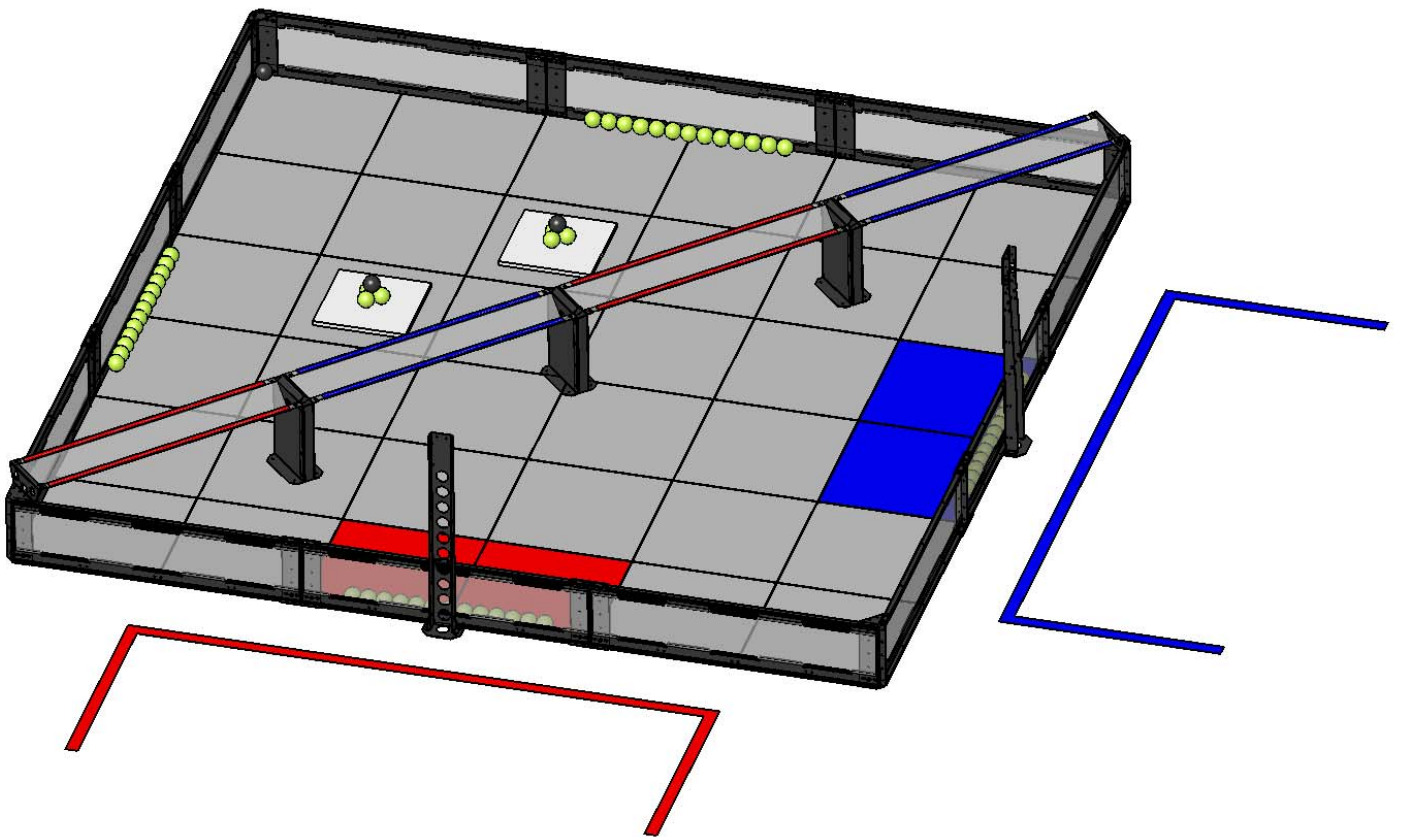
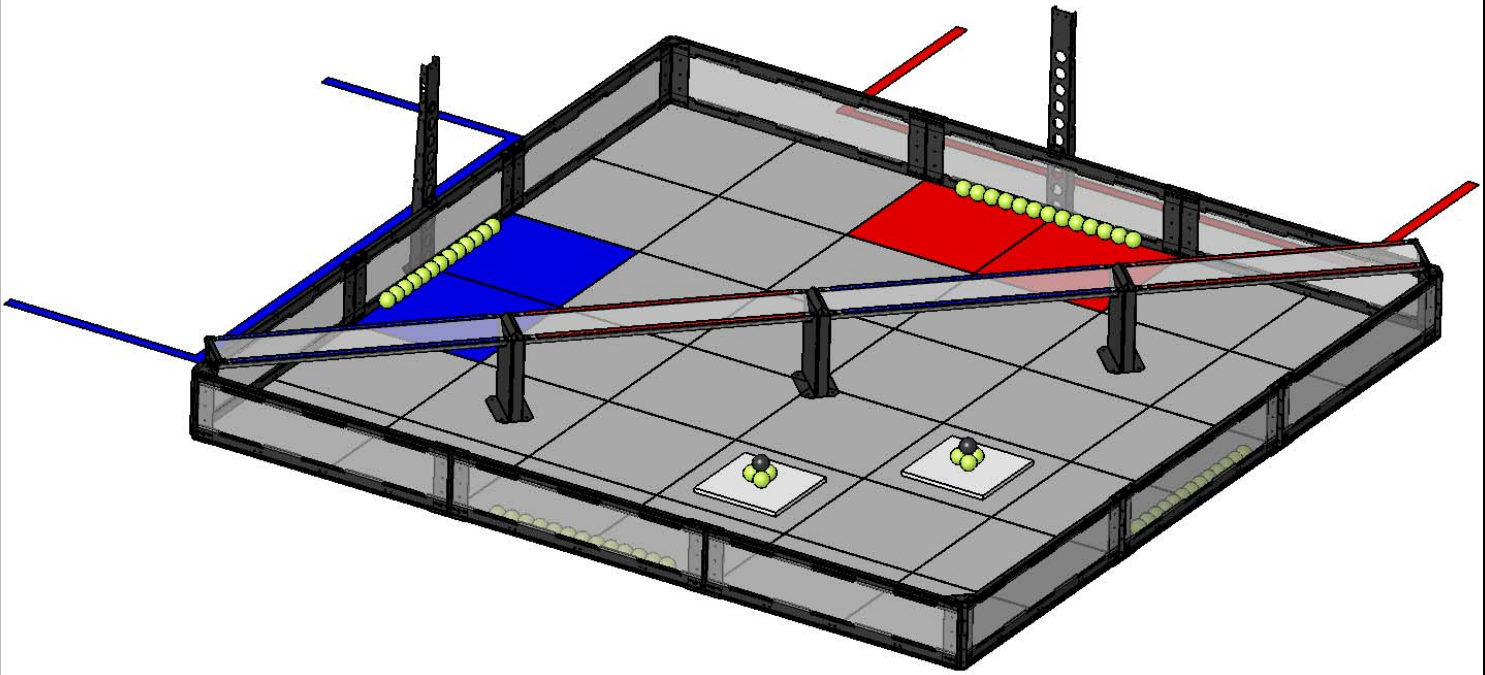

Printed on 8/14/2007 ALL DIMENSIONS ARE IN INCHES.

VexRobotics.com
Overall Field Layout